

# **Design** Beyond **Borders**



# Silva Shero

---

Born in Kurdistan, raised in the Czech Republic, and now calling Germany home, I bring a mix of cultures into everything I create.

Journey

Education

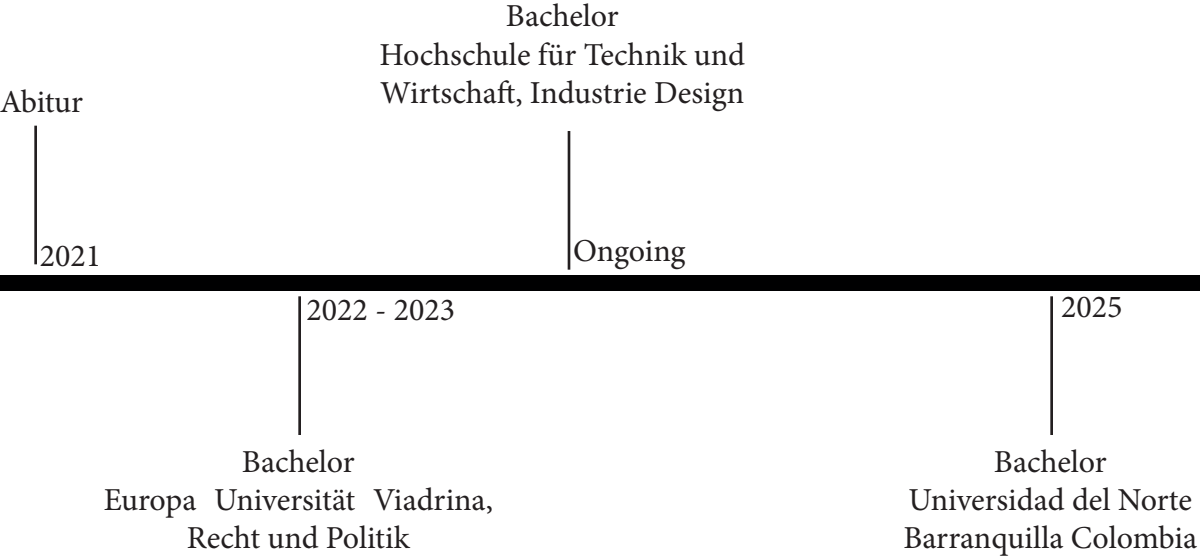

Work experience

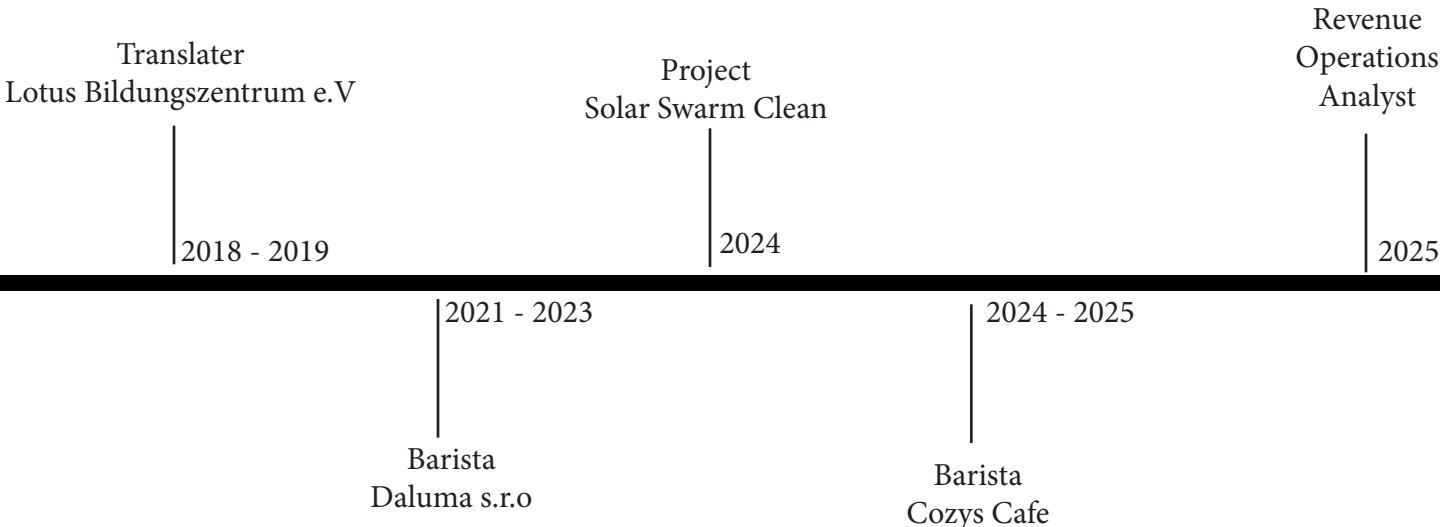

Languages



Skills

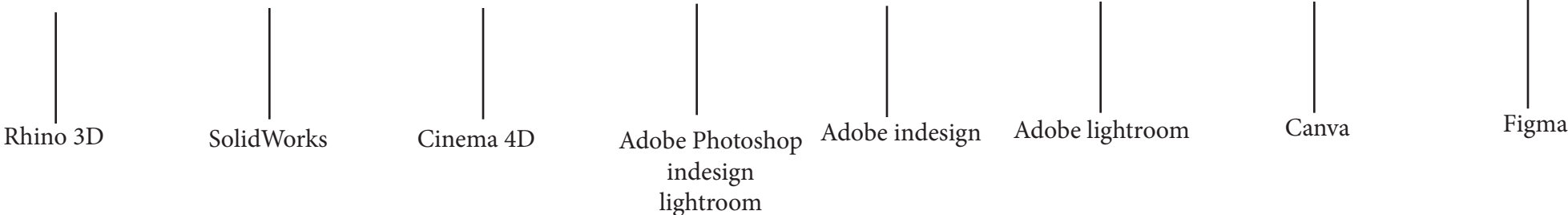

# PROJECTS

Glowing Guard

Solidpress

Perfect connections

Lumina

Moery



## Glowing Guard

The project involves the development of a practical tool for camping and outdoor activities that combines two essential functions: a first aid kit with an integrated flashlight. Various products were analyzed to evaluate aspects such as functionality, technology, target groups, and design.

The result is a compact and handy design that maintains the colors white and red to emphasize hygiene and clear functional identification. The revised design also allows for easy attachment to a carabiner or backpack, significantly enhancing practicality.







# Solidpress

The Solidpress combines elegant design with high functionality. Ergonomic handles ensure comfortable use and allow effortless juicing with minimal effort. Its intuitive operation makes it ready to use immediately.

Its compact design requires little space and can be easily stored in drawers or on shelves.

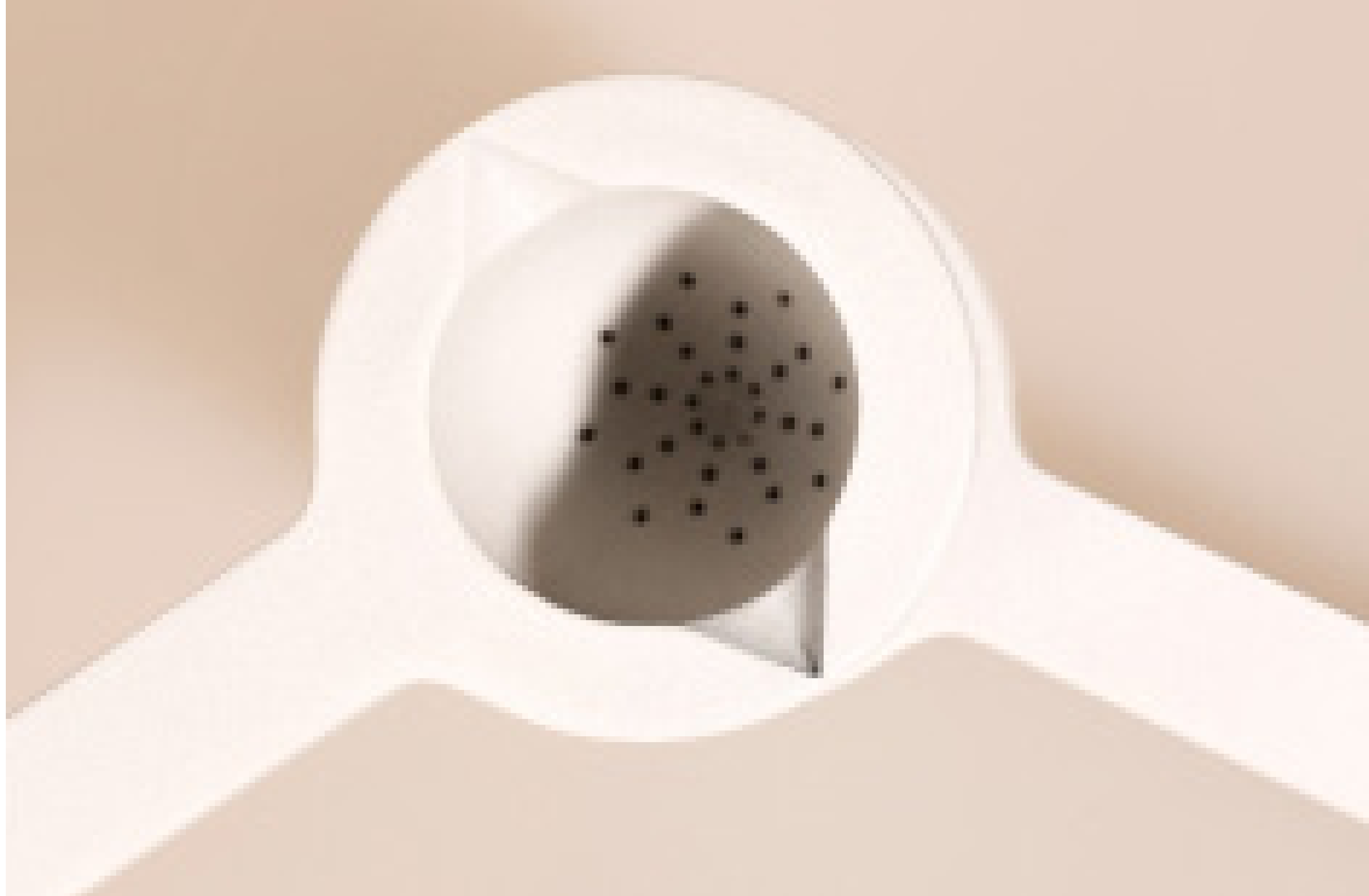



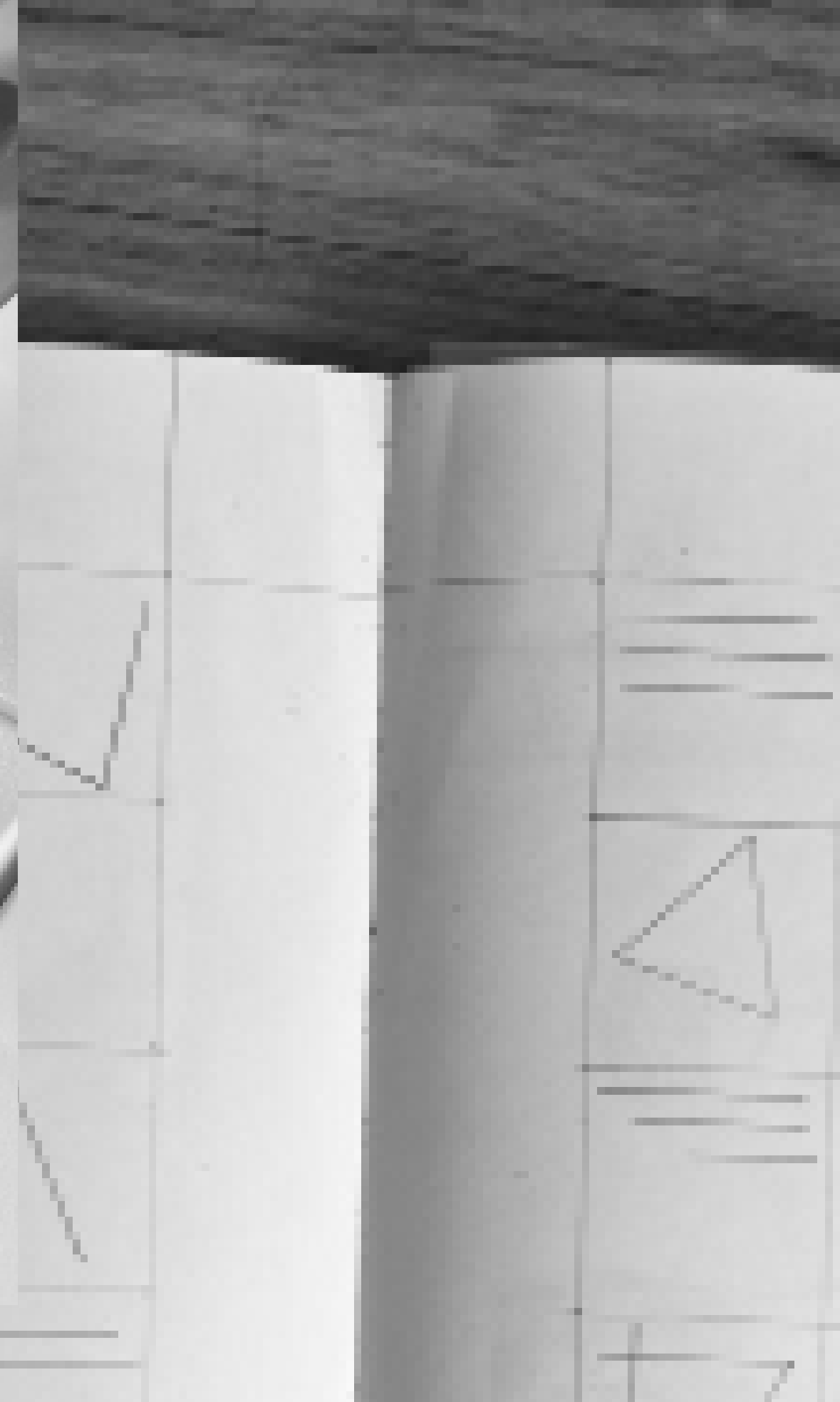
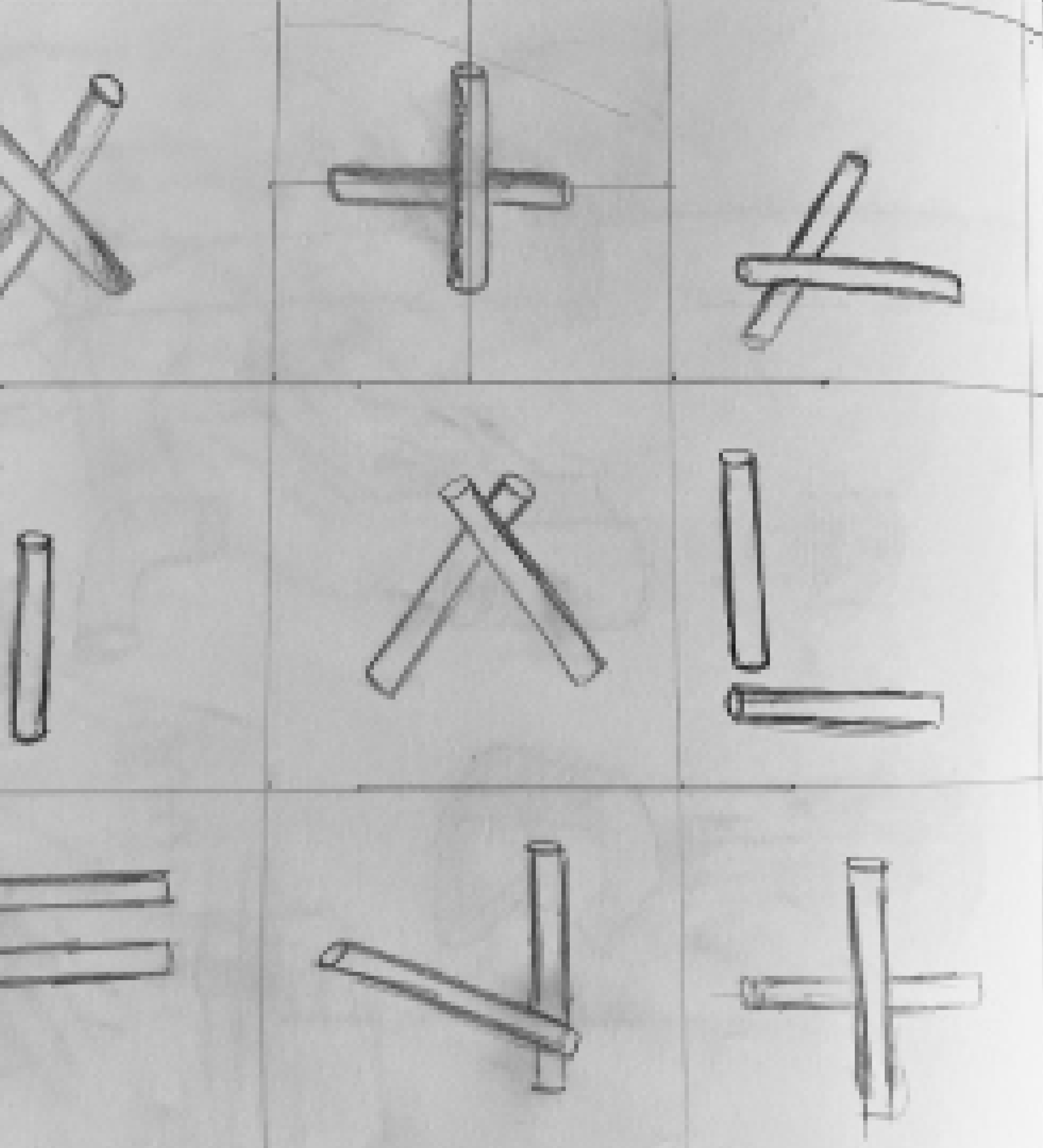

**Perfect Connections**



**The connecting rings combine functionality and aesthetics using high-quality leather and embedded magnets, enabling flexible connections for beech round rods (300 x 20 mm). Durable leather ensures a modern, timeless look, while strong neodymium magnets allow secure, tool-free assembly for two- or three-rod configurations.**

**The modular design supports various arrangements, making the rings ideal for furniture, creative structures, and reconfigurable designs. Sustainable and reusable, they offer a stylish blend of natural and industrial materials, appealing to those seeking innovative, adaptable, and eco-conscious solutions.**



## Lumina

Lumina an advanced Brain-to-Brain Communication (BBC) technology that enables the direct transmission of thoughts, emotions, and memories between individuals. By using nano-computers and selfhealing materials, Lumina allows users to truly experience another person's perspective, rather than just imagining it.

This revolutionary system is designed for applications in justice, therapy, and education, helping to bridge the gap between understanding and action.

In criminal rehabilitation, Lumina enables offenders to directly feel the impact of their actions, fostering true accountability and emotional awareness. In therapy, it provides a safe space for trauma processing and deeper emotional insight. In education, it transforms learning by allowing students to relive historical events or step into the lives of others, fostering greater empathy and understanding.

Sketches

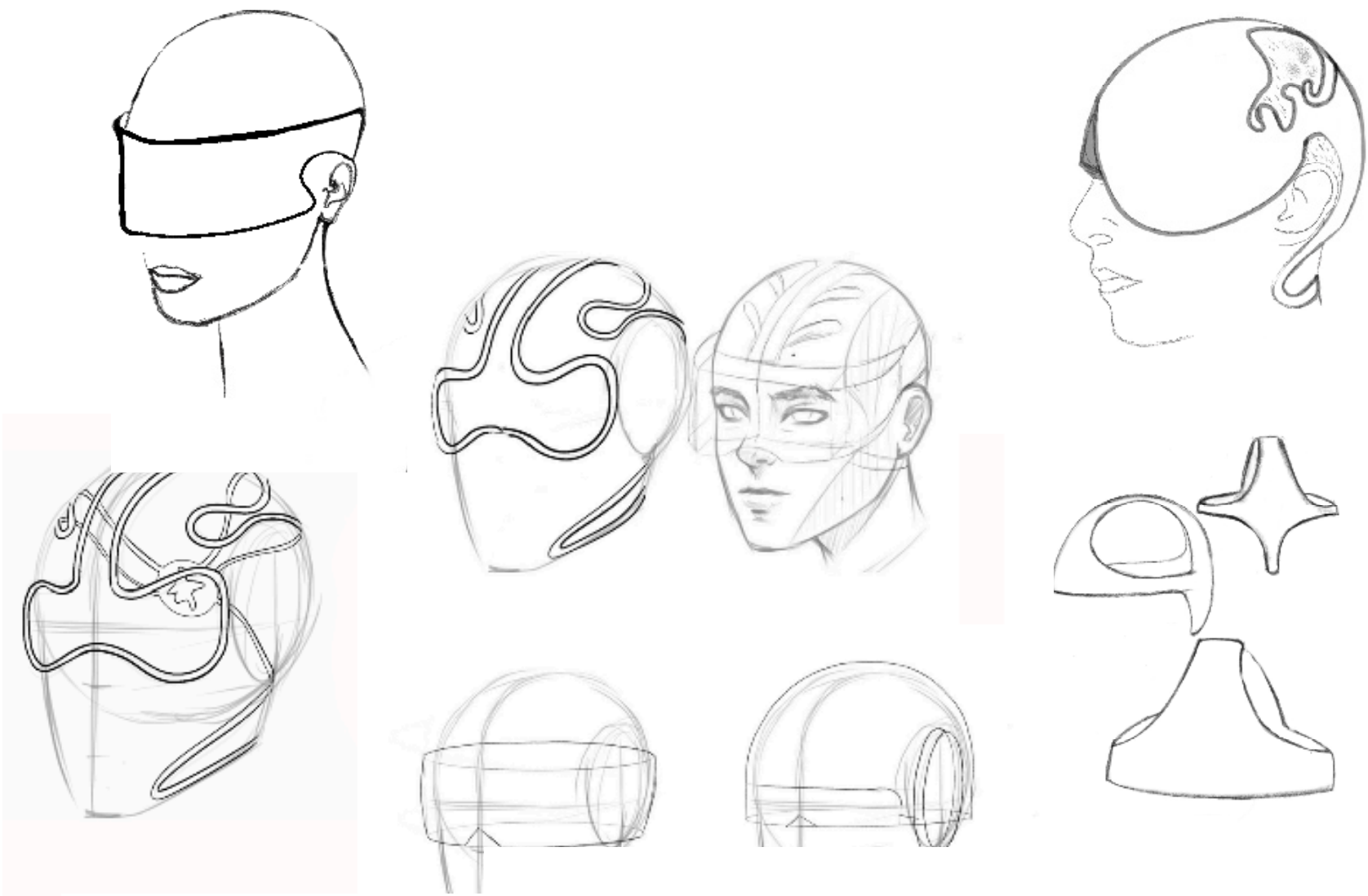

Technical Aspects

Components

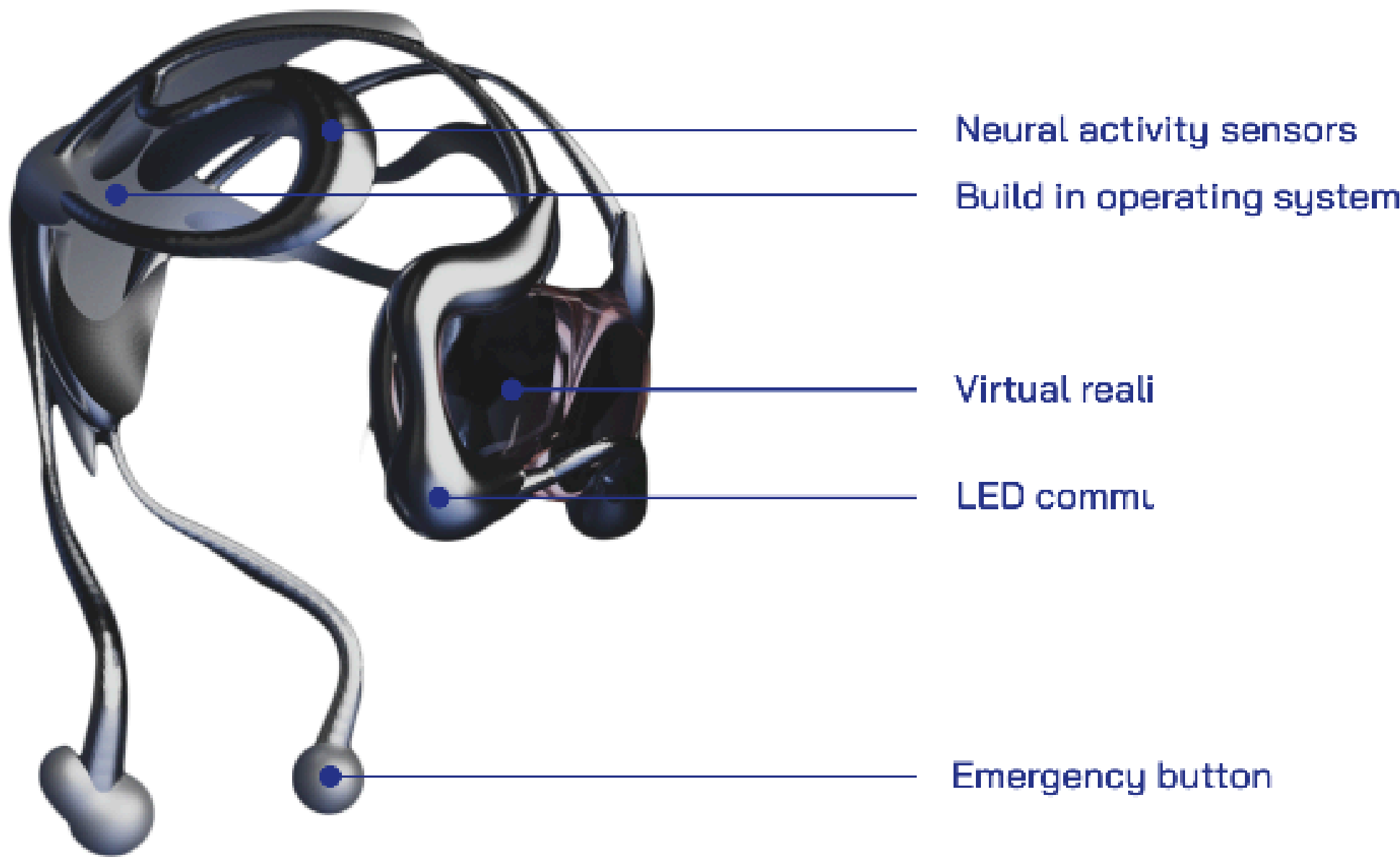

Neuralink Chip

Neuralink is developing a fully implantable brain computer interface designed to enable users to control computers or mobile devices directly with their thoughts. The device is intended to be cosmetically invisible and aims to assist individuals with neurological conditions.



Graphine

Graphene’s exceptional strength, flexibility, and conductivity make it a key component in self-healing materials. These materials are designed to automatically repair damage, enhancing durability and reducing maintenance needs. Applications span from electronics and coatings to medicine and construction, where graphene based solutions can improve longevity and performance in everyday objects, infrastructure, and medical devices.



# Moery



Emory ist ein modulares Erinnerungsobjekt, das Trauer sichtbar macht und Verbindung schafft. Bestehend aus stapelbaren, individuell gestaltbaren Platten, wird es an einem Grab oder einem anderen Gedenkort platziert. Jede Platte trägt eine persönliche Gravur Worte, Symbole oder Geschichten, die an die verstorbene Person erinnern.

Einzelne Platten können leicht herausgezogen, aber nicht vollständig entfernt werden. So bleibt jede Berührung sichtbar ein Zeichen dafür, dass jemand da war, erinnert hat, verbunden ist. Mit jeder Interaktion wächst ein kollektives Bild aus Trauer, Liebe und Weiterleben.

Emory ersetzt nicht nur klassische Erinnerungsformen wie Urnen oder Gedenktafeln es ergänzt sie durch einen stillen, gemeinschaftlichen Austausch. Es lädt ein zur Begegnung mit der Erinnerung, mit sich selbst, mit anderen.



## Sketches

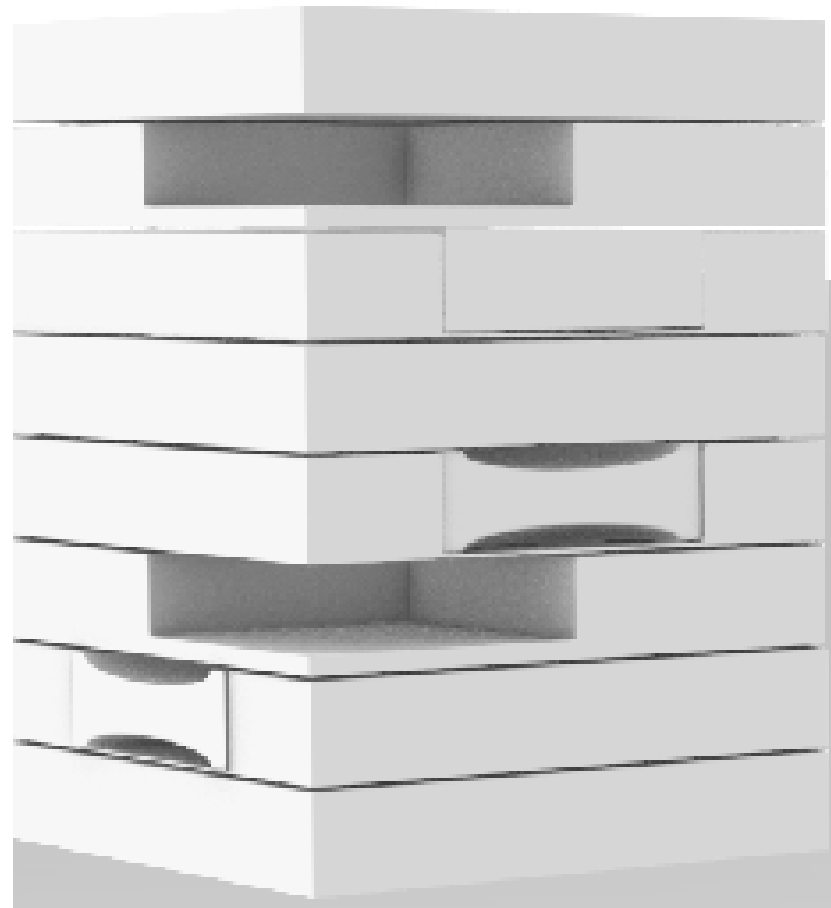



Materials

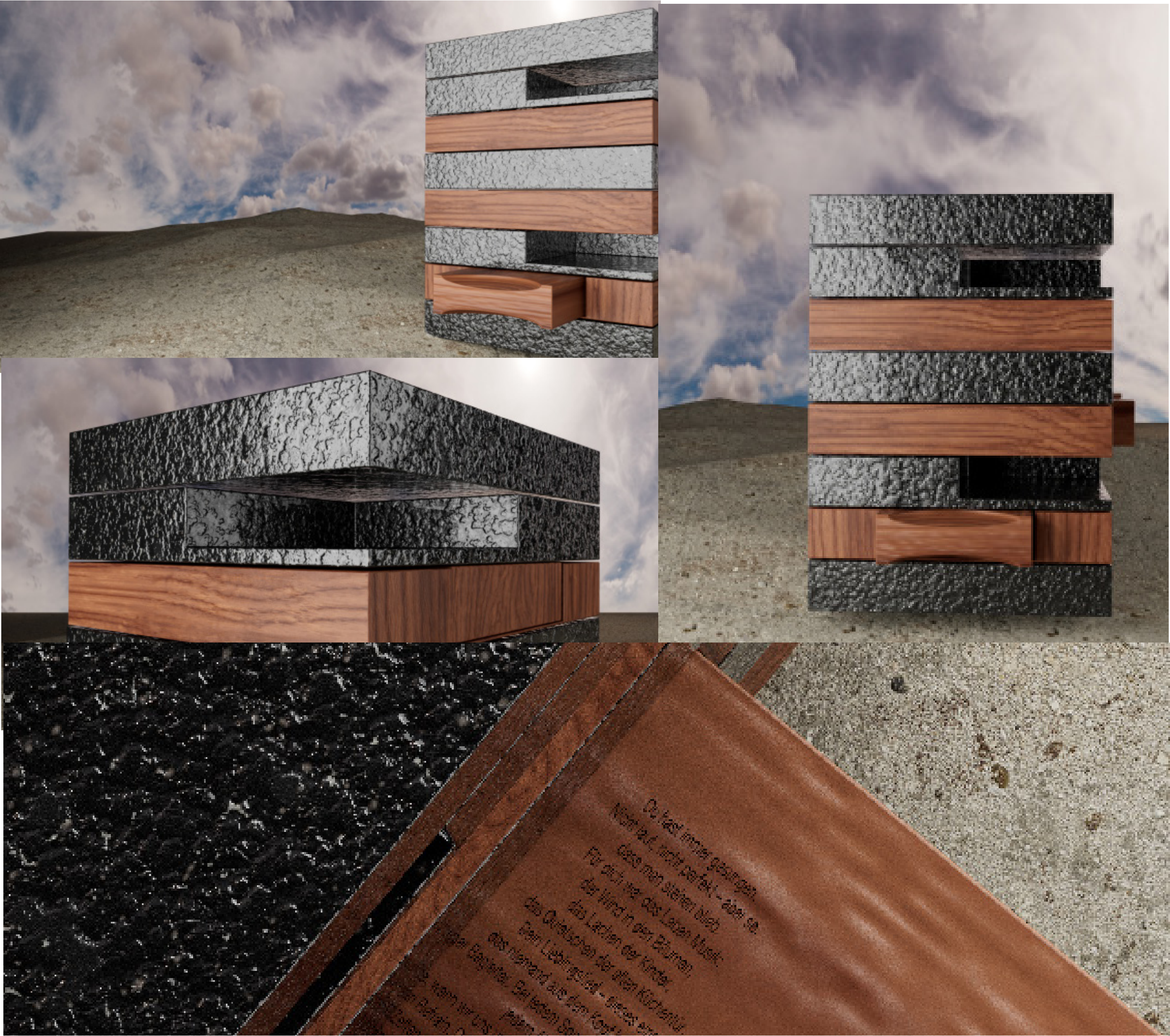

Wood

Neuralink is developing a fully implantable brain-computer interface designed to enable users to control computers or mobile devices directly with their thoughts. The device is intended to be cosmetically invisible and aims to assist individuals with neurological conditions.

Wet asphalt

Graphene’s exceptional strength, flexibility, and conductivity make it a key component in self-healing materials. These materials are designed to automatically repair damage, enhancing durability and reducing maintenance needs. Applications span from electronics and coatings to medicine and construction, where graphene based solutions can improve longevity and performance in everyday objects, infrastructure, and medical devices.



Designing beyond borders means crafting farewells that linger,  
leaving behind bridges where walls once stood.

## Lets connect!

Silva Shero

Midyashero@gmail.com

+49 15758907326

Bernhard-Bästlein-Straße 35  
10367 Berlin

Visit my Website!  
[silvashero.com](http://silvashero.com)

